

# INSTA-LOCK™ TYPE F

## MALE ADAPTOR X MALE BSP THREAD



### Product specifications

Size inch	Aluminum	Stainless Steel	Max. width across adaptor (O) inch	Overall Length (L) inch	Exposed Length (E) inch	Minimum ID (I) inch	Distance chain lug extends from BOD inch
1/2	F050AL	F050SS	1.150	2.250	1.531	0.469	0.375
3/4	F075AL	F075SS	1.688	2.375	1.656	0.688	0.375
1	F100AL	F100SS	1.750	2.819	2.038	0.875	0.375
1 1/4	F125AL	F125SS	2.130	3.156	2.279	1.187	0.375
1 1/2	F150AL	F150SS	2.300	3.222	2.347	1.437	0.375
2	F200AL	F200SS	2.909	3.593	2.596	1.750	0.375
2 1/2	F250AL	F250SS	3.281	4.218	2.812	2.187	0.375
3	F300AL	F300SS	3.844	4.343	2.875	2.812	0.375
4	F400AL	F400SS	4.994	4.746	3.184	3.734	0.375
5	F500AL	F500SS	6.188	4.906	3.125	4.688	0.375
6	F600AL	F600SS	7.500	5.219	3.313	5.750	0.375

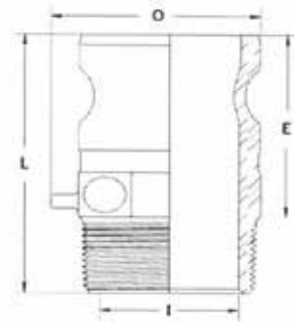

Also available in NPT Thread ex USA.

**Note:** Contitech® Insta-Lock fittings are never to be used in steam or compressed air service. Contitech® Insta-Lock cam arms are designed exclusively for Insta-Lock fittings.

### APPLICATIONS

Type F fitting is normally threaded onto a pipe, or manifold connections and mated with Part C, Part B or Part D. Used in applications that require frequent connections. Insta-Lock™ fittings are designed for liquids and dry bulk. Consult the chemical resistance guide for specific chemical recommendations.

### MATERIALS

Aluminum, 316# stainless steel and brass.

### PRESSURE RATING

Sizes 1/2"-2", 250 psi; sizes 2 1/2"-4", 150 psi; sizes 5"-6", 75 psi. Recommended working pressure ratings based on ambient temperature 70°F (21°C) with Standard Nitrile gaskets.

### CONSTRUCTION

**Branding:** Contitech® F200SS.



**Please Note:** We reserve the right to make technical changes without notice.