

2640M CHEMJEC

CHEMICAL & TEMPERATURE RESISTANT



Hose applications

#	Ø				Pressure		Burst		Bend radius	Weight	Collapse pressure	Max length	
	DN	size	mm	inch	bar	psi	bar	psi					
2640M-08V38	12	-08	12.9	1/2	24.7	1035	15,000	4140	60,000	200.0	0.86	60	4,000

APPLICATIONS

Medium pressure, high temperature, applications for use with aggressive chemicals such as hydrochloric acid. Long length subsea umbilical hose.

FEATURES

- Withstands high pressure cycles with no signs of stress cracking
 - Proven to handle methanol
 - High collapse resistance (HCR) and also providing longer service life
 - Meets or exceeds the performance requirements of ISO 13628-5 / API 17E
 - Excellent chemical resistance
- NOT recommended for gas application.

CONSTRUCTION

Core tube: Coextruded core tube with fluoropolymer inside.
Pressure reinforcement: High strength wire, synthetic fibre.
Cover: PA12.
Colour: Gold.

TEMPERATURE RANGE

-40°C up to +100°C, short term 125°C.
 -40°F up to +212°F, short term 257°F.

FITTINGS

Type "M" female swivel fitting: Special stainless steel materials.

#	Ø				Thread	A	B	H	Pressure	
	DN	size	mm	inch					bar	psi
1AY5X-11-08C-M-Subsea	12	-08	12.7	1/2	1 - 12 UNF-2B	111.0	56.0	32.0	1035	15,000

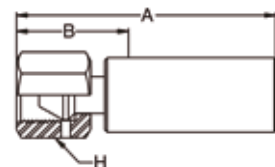

Metric swivel with O-ring heavy series: Special stainless steel materials.

#	Ø				Thread	A	B	H	Pressure	
	DN	size	mm	inch					bar	psi
1C95X-16-08C-M-Subsea	12	-08	12.7	1/2	M24 x 1.5	88.0	34.0	32.0	1030	15,000

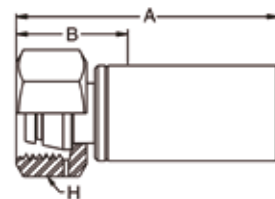

Medium pressure tube nipple: Special stainless steel materials.

#	Ø				Thread	A	B	Pressure	
	DN	size	mm	inch				bar	psi
1Y25X-9-08C-M-Subsea	12	-08	12.7	1/2	9/16 - 18 UNF- LH	164.2	72.0	1035	15,000
1Y25X-12-08C-M-Subsea	12	-08	12.7	1/2	3/4 - 16 UNF- LH	174.2	84.0	1035	15,000

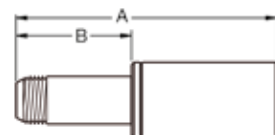

Please Note: Variety of fittings in mild steel or stainless steel available, other fittings available on request. We reserve the right to make technical changes without notice.