

2340N - 10,000 PSI WIRE REINFORCED OFFSHORE HOSE



Oil and Gas applications

| # | Ø | | | | Ø | | ⌚ | | 🌿 | | 📐 | | Kg | Collapse pressure | Max length |
|-------------|----|------|-----|------|------|-----|--------|------|--------|------|------|-----|-------|-------------------|------------|
| | DN | size | mm | inch | mm | bar | psi | bar | psi | mm | kg/m | | | | |
| 2340N-04V91 | 6 | -04 | 6.4 | 1/4 | 12.5 | 690 | 10,000 | 2760 | 40,000 | 70.0 | 0.23 | 154 | 3,500 | | |

APPLICATIONS

High pressure hose used in HFL's, jumpers, long length umbilicals, 10,000 psi tooling and testing.

FEATURES

- Low dimensional change under pressure
- Smooth bore for low pressure drop
- Offshore safety factor standard (4:1 SF)
- Meets or exceeds the performance requirements of ISO 13628-5 / API 17E
- Methanol washed Nylon PA11 core tube
- Long length subsea umbilical hose
- Available in long continuous length up to 3,500m

CONSTRUCTION

Core tube: Methanol washed PA11.
Pressure reinforcement: High strength wire.
Cover: PA12.
Colour: Black.

TEMPERATURE RANGE

-40°C up to +100°C, max. 70°C for water or methanol based fluids.
 -40°F up to +212°F, max. 158°F for water or methanol based fluids.

FITTINGS

NPT Male: Stainless steel (AISI 316), other materials on request.

| # | Ø | | | | 🌿 | A | B | H | ⌚ | |
|-------------|----|------|-----|------|---------|------|------|------|------|--------|
| | DN | size | mm | inch | | | | | bar | psi |
| 1018X-4-04C | 6 | -04 | 6.4 | 1/4 | 1/4 NPT | 60.0 | 28.0 | 16.0 | 1100 | 16,000 |

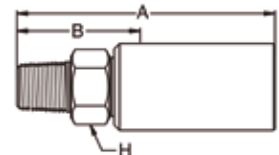

JIC Female swivel fitting: Stainless steel (AISI 316), other materials on request.

| # | Ø | | | | 🌿 | A | B | H | ⌚ | |
|-------------|----|------|-----|------|---------------|------|------|------|------|--------|
| | DN | size | mm | inch | | | | | bar | psi |
| 1068X-4-04C | 6 | -04 | 6.4 | 1/4 | 7/16 - 20 UNF | 68.5 | 35.5 | 19.0 | 690 | 10,000 |
| 1068X-6-04C | 6 | -04 | 6.4 | 1/4 | 9/16 - 18 UNF | 66.0 | 33.0 | 19.0 | 1035 | 15,000 |

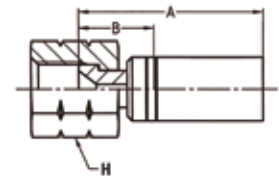

BSP Female swivel fitting: Stainless steel (AISI 316), other materials on request.

| # | Ø | | | | 🌿 | A | B | H | ⌚ | |
|-------------|----|------|-----|------|-------|------|------|------|-----|--------|
| | DN | size | mm | inch | | | | | bar | psi |
| 1928X-4-04C | 6 | -04 | 6.4 | 1/4 | G 1/4 | 56.0 | 32.0 | 19.0 | 690 | 10,000 |

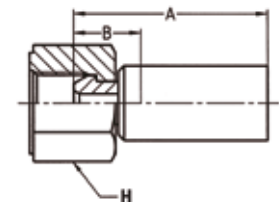



Please Note: Variety of fittings in mild steel or stainless steel available, other fittings available on request. We reserve the right to make technical changes without notice.

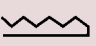

2340N - 10,000 PSI WIRE REINFORCED OFFSHORE HOSE

Metric swivel nut with O-ring Heavy series: Stainless steel (AISI 316), other materials on request.

| # |  | | | |  | A | B |  |  | |
|--------------|---|------|-----|------|---|------|------|---|---|--------|
| | DN | size | mm | inch | | | | | mm | mm |
| 1C98X-8-04C | 6 | -04 | 6.4 | 1/4 | M16 x 1.5 | 59.0 | 27.0 | 19.0 | 690 | 10,000 |
| 1C98X-10-04C | 6 | -04 | 6.4 | 1/4 | M18 x 1.5 | 65.0 | 33.0 | 22.0 | 690 | 10,000 |

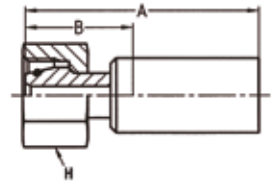

Medium pressure tube nipple: Stainless steel (AISI 316), other materials on request.

| # |  | | | |  | A | B |  | |
|-------------|---|------|-----|------|---|-------|------|---|--------|
| | DN | size | mm | inch | | | | mm | mm |
| 1Y28X-6-04C | 6 | -04 | 6.4 | 1/4 | 3/8 - 24 LH | 120.0 | 87.0 | 1380 | 20,000 |

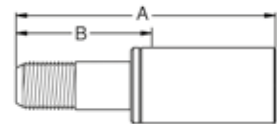

Please Note: Variety of fittings in mild steel or stainless steel available, other fittings available on request. We reserve the right to make technical changes without notice.