

2240N-48V80

3" - 5,000 PSI BLACK EAGLE



Offshore applications

#									Test pressure			Collapse pressure	Max length
	mm	inch	mm	inch	bar	psi	bar	psi	bar	mm	kg/m	bar	mtr
2240N-48V80	75.0	3	114.0	4.49	345	5,000	862	12,500	518	1000.0	11.50	20	500

APPLICATIONS

Designed for use in acidising, cementing, methanol injection, well stimulation and control fluids. Used as an alternative to steel pipe, flexible pipe and rubber hose. Can be used onshore or offshore.

FEATURES

- ColorGard, visual early warning system
- Nylon 11 core tube offers high cleanliness
- Available in long continuous lengths
- Smaller OD than flexible pipe allows more hose per reel
- Excellent chemical resistance providing long service life
- More efficient deployment and recovery
- DNV Type Approval (API 7K and API 17J)

CONSTRUCTION

Core tube: PA11, methanol washed.
Pressure reinforcement: 2 layers of high tensile steel wire.
Cover: Extra thick dual layer TPU sheath.
Colour: ColorGard™ – red inner sheath and black outer sheath.

TEMPERATURE RANGE

-40°C up to +70°C / -40°F up to 158°F.

FITTINGS

1502 Hammerlug union female

#		A	B	
		mm	mm	bar
1HNTX-48-48	5 3/8 - 3 1/2 ACME	350.0	184.0	1035

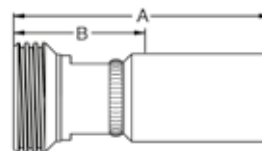

1502 Hammerlug union male

#		A	B	
		mm	mm	bar
1HETX-48-48-FLAT	5 3/8 - 3 1/2 ACME	378.0	212.0	1035

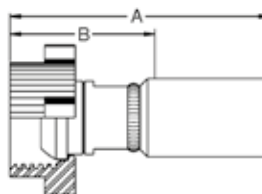

602 Hammerlug union female

#		A	B	
		mm	mm	bar
1HNTX-48-48-602	5 3/8 - 3 ACME	350.0	184.0	345

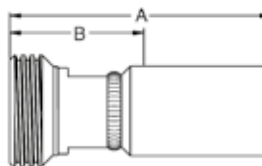



Please Note: Variety of fittings in mild steel or stainless steel available, other fittings available on request. We reserve the right to make technical changes without notice.



2240N-48V80



3" - 5,000 PSI BLACK EAGLE

602 Hammerlug union male

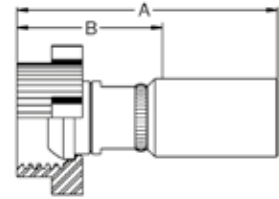
#		A	B	
		mm	mm	bar
1HETX-48-48-FLAT-602	5 3/8 - 3 ACME	372.0	206.0	345



API flange, swivel

#		A	B	ØR	Seal	
		mm	mm	mm		bar
18KTX-65-48-API17DSV-10K-L	4 1/16 10,000 psi	427.0	261.0	315.0	BX155	690

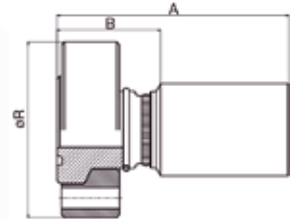

Please Note: Variety of fittings in mild steel or stainless steel available, other fittings available on request. We reserve the right to make technical changes without notice.