

R13

FOUR & SIX SPIRAL WIRE HOSE



Hydraulic applications

#											
	mm	inch	mm	bar	psi	bar	psi	mm	kg/m		
R13-4	14.6	0.57	17.6	690	10,000	3250	47,130	120.0	0.66		
R13-6	17.4	0.69	20.4	690	10,000	2900	42,060	150.0	0.83		
R13-8	21.5	0.85	24.5	620	8,990	2500	36,250	200.0	1.14		
R13-12	29.0	1.14	31.8	350	5,070	1950	28,280	240.0	1.63		
R13-16	36.0	1.42	39.2	350	5,070	1650	23,930	300.0	2.19		
R13-20	47.0	1.85	50.0	350	5,070	1500	21,750	420.0	3.6		
R13-24	54.6	2.15	57.5	350	5,070	1600	23,200	500.0	4.7		
R13-32	68.4	2.69	72.0	350	5,070	1500	21,750	630.0	6.8		

APPLICATIONS

Heavy duty lines, hydrostatic transmissions, in heavy duty environmental conditions, specific installations with severe abrasion conditions, marine applications, underground and open pit mining.

FEATURES

- Approved at 1,000,000 flexing impulse cycles
- Superior abrasion resistance
- High ozone and weather resistance
- Flame resistance to a wide range of specification
- Biological and mineral oils compatibility

CONSTRUCTION

- Core tube:** Oil resistant synthetic rubber.
- Pressure reinforcement:** Four high tensile steel spirals (DN 6-25).
Six high tensile steel spirals (DN 31-51).
- Cover:** Synthetic rubber with high ozone, weather and heat resistance.

TEMPERATURE RANGE

-40°C to +121°C.

FITTINGS

Female metric heavy series

					A	B	
DN	inch	size	mm		mm	mm	mm
16	5/8	-10	15.9	M24 x 1.5	67.0	28.0	30.0
16	5/8	-10	15.9	M30 x 2	67.0	28.0	36.0
19	3/4	-12	19.1	M30 x 2	76.0	30.0	36.0
19	3/4	-12	19.1	M36 x 2	76.6	30.6	46.0
25	1	-16	25.4	M42 x 2	89.0	35.0	50.0
31	1 1/4	-20	31.8	M42 x 2	102.0	39.0	50.0

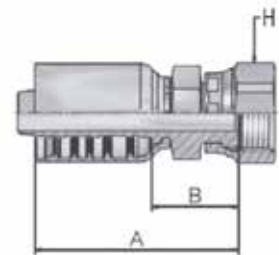

Please Note: Variety of fittings in mild steel or stainless steel available, other fittings available on request. We reserve the right to make technical changes without notice.



R13

FOUR & SIX SPIRAL WIRE HOSE

RUBBER HOSE - HYDRAULIC

Female BSP 60° cone

					A	B	
DN	inch	size	mm		mm	mm	mm
19	3/4	-12	19.1	3/4 x 14	73.0	27.0	32.0
19	3/4	-12	19.1	1 x 11	85.0	39.0	41.0
25	1	-16	25.4	3/4 x 14	83.0	29.0	32.0
25	1	-16	25.4	1 x 11	91.0	37.0	41.0
31	1 1/4	-20	31.8	1 1/4 x 11	98.0	34.0	50.0

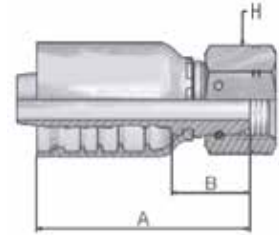

Male NPTF pipe - rigid

					A	B	
DN	inch	size	mm		mm	mm	mm
19	3/4	-12	19.1	1/2 x 14	87.0	41.0	30.0
19	3/4	-12	19.1	3/4 x 14	87.0	41.0	30.0
25	1	-16	25.4	1 x 11 1/2	103.0	49.0	36.0
31	1 1/4	-20	31.8	1 1/4 x 11	116.0	53.0	46.0
38	1 1/2	-24	38.1	1 1/2 x 11	124.0	57.0	50.0

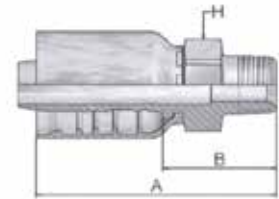

Female JIC 37° - swivel

					A	B		
DN	inch	size	mm		mm	mm	mm	mm
16	5/8	-10	15.9	7/8 x 14	81.0	42.0	27.0	24.0
16	5/8	-10	15.9	1 1/16 x 12	84.0	45.0	32.0	30.0
19	3/4	-12	19.1	7/8 x 14	92.0	46.0	27.0	30.0
19	3/4	-12	19.1	1 1/16 x 12	94.0	48.0	32.0	30.0
19	3/4	-12	19.1	1 5/16 x 12	99.0	53.0	41.0	36.0
25	1	-16	25.4	1 1/16 x 12	102.0	48.0	32.0	36.0
25	1	-16	25.4	1 5/16 x 12	106.0	52.0	41.0	36.0
25	1	-16	25.4	1 5/8 x 12	109.0	55.0	50.0	41.0
31	1 1/4	-20	31.8	1 5/16 x 12	120.0	57.0	41.0	46.0
31	1 1/4	-10	31.8	1 5/8 x 12	124.0	60.0	50.0	46.0
31	1 1/4	-20	31.8	1 7/8 x 12	108.0	44.0	60.0	50.0
38	1 1/2	-24	38.1	1 7/8 x 12	136.0	69.0	60.0	50.0

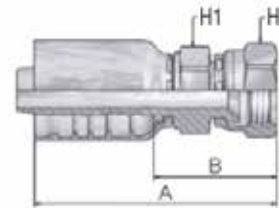

1502 Hammerlug union female

	A	B	
	mm	mm	bar
4 1/8 - 3 ACME	286.0	149.0	1035

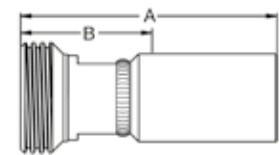

1502 Hammerlug union male

	A	B	
	mm	mm	bar
4 1/8 - 3 ACME	241.0	105.0	1035

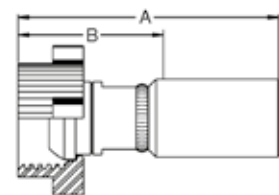

Please Note: Variety of fittings in mild steel or stainless steel available, other fittings available on request. We reserve the right to make technical changes without notice.