



2448M CHEMJEC CHEMICAL & TEMPERATURE RESISTANT

Hose applications

#												Collapse pressure	Max length
	DN	size	mm	inch	mm	bar	psi	bar	psi	mm	kg/m	bar	mtr
2448M-04V38	6	-04	6.5	1/4	13.7	1035	15,000	4140	60,000	230.0	0.38	378	3,000
2448M-05V38	8	-05	8.2	5/16	16.3	1035	15,000	4140	60,000	230.0	0.52	385	2,500
2448M-06V38	10	-06	9.9	3/8	20.1	1035	15,000	4140	60,000	200.0	0.83	390	3,000

APPLICATIONS

Long length subsea umbilical hose. High pressure, high temperature, applications for use with aggressive chemicals. Long length subsea umbilical hose.

FEATURES

- Withstands high pressure cycles with no signs of stress cracking. High collapse resistance (HCR) while also providing long service life
 - Meets or exceeds the performance requirements of ISO 13628-5 / API 17E
 - Coextruded fluoropolymer core tube for extreme chemical resistance
 - Excellent chemical resistance
- NOT recommended for gas applications.

CONSTRUCTION

Core tube: Coextruded core tube with fluoropolymer inside.
Pressure reinforcement: High strength wire.
Cover: PA12.
Colour: Gold.

TEMPERATURE RANGE

-40°C up to +100°C, short term 125°C.
 -40°F up to +212°F, short term 257°F.

FITTINGS

Type "M" female swivel fitting: Special stainless steel materials.

#						A	B			
	DN	size	mm	inch		mm	mm	mm	bar	psi
1AYUX-6-04C	6	-04	6.4	1/4	9/16 - 18 UNF	86.0	34.0	19.0	1035	15,000
1AYUX-8-05C	8	-05	7.9	5/16	3/4 - 16 UNF	100.0	35.0	27.0	1035	15,000
1AYUX-8-06C	10	-06	9.5	3/8	3/4 - 16 UNF	93.5	38.5	27.0	1035	15,000

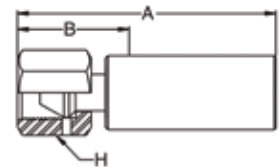

Medium pressure tube nipple: Special stainless steel materials.

#						A	B		
	DN	size	mm	inch		mm	mm	bar	psi
1Y2UX-6-04C	6	-04	6.4	1/4	3/8 - 24 UNF-LH	131.5	63.5	1380	20,000
1Y2UX-6-05-INC625	8	-05	7.9	5/16	3/8 - 24 UNF-LH	125.4	63.5	1380	20,000
1Y2UX-9-06C	10	-06	9.5	3/8	9/16 - 18 UNF-LH	151.0	72.0	1380	20,000

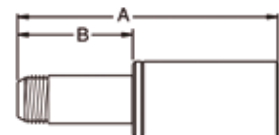

Please Note: Variety of fittings in mild steel or stainless steel available, other fittings available on request. We reserve the right to make technical changes without notice.