

# 2440N-48V80

## 3" - 10,000 PSI BLACK EAGLE



### Offshore applications

#									Test pressure			Collapse pressure	Max length
	mm	inch	mm	inch	bar	psi	bar	psi					
2440N-48V80	75.0	3	122.0	4.80	690	10,000	1725	25,000	1035	1100.0	18.70	66	450

### APPLICATIONS

Designed for use in acidising, cementing, methanol injection, well stimulation and control fluids. Used as an alternative to steel pipe, flexible pipe and rubber hose. Can be utilised onshore or offshore.

### FEATURES

- ColorGard, visual early warning system
- Nylon 11 core tube offers high cleanliness
- Available in long continuous lengths
- Smaller OD than flexible pipe allows more hose per reel
- Excellent chemical resistance providing long service life
- More efficient deployment and recovery
- DNV Type approval (API7K and API 17J)

### CONSTRUCTION

**Core tube:** PA11, methanol washed.  
**Pressure reinforcement:** 6 layers of high tensile steel wire.  
**Cover:** Extra thick dual layer TPU sheath.  
**Colour:** ColorGard™ – red inner sheath and black outer sheath.

### TEMPERATURE RANGE

-40°C up to +70°C / -40°F up to 158°F.

### FITTINGS

#### 1502 Hammerlug union female

#		A	B	
		mm	mm	bar
1HNLX-48-48	5 3/8 - 3 1/2 ACME	405.0	194.0	1035

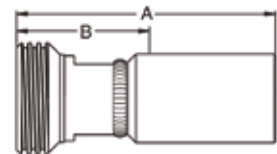

#### 1502 Hammerlug union male

#		A	B	
		mm	mm	bar
1HELX-48-48-FLAT	5 3/8 - 3 1/2 ACME	395.0	184.0	1035

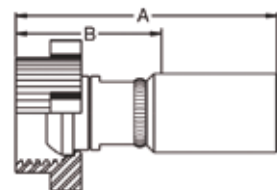

#### API flange, swivel

#	API size	A	B	ØR	Seal	
		mm	mm	mm		bar
18KLX-49-48-API17DSV-10K	3 1/16 10,000 psi	455.0	244.0	270.0	BX154	690
18KLX-65-48-API17DSV-10K	4 1/16 10,000 psi	482.0	246.0	315.0	BX155	690

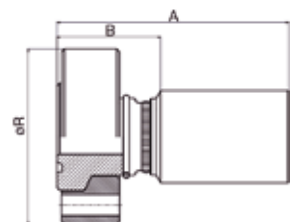

**Please Note:** Variety of fittings in mild steel or stainless steel available, other fittings available on request. We reserve the right to make technical changes without notice.