



# 2448N-32V80

## 2" - 5,000 PSI BLACK EAGLE

### Offshore applications

#									Test pressure			Collapse pressure	Max length
	mm	inch	mm	inch	bar	psi	bar	psi	bar	mm	kg/m	bar	mtr
2448N-32V80	50.5	2	80.5	3.17	345	5,000	1380	20,000	518	500.0	8.50	49	1,000

### APPLICATIONS

Designed for use in acidising, cementing, methanol injection, well stimulation and control fluids. Used as an alternative to steel pipe, flexible pipe and rubber hose. Can be utilised onshore or offshore.

### FEATURES

- ColorGard, visual early warning system
- Nylon 11 core tube offers high cleanliness
- Available in long continuous lengths
- Smaller OD than flexible pipe allows more hose per reel
- Excellent chemical resistance providing long service life
- More efficient deployment and recovery
- DNV Type Approval (API 7K and API 17J)

### CONSTRUCTION

**Core tube:** PA11, methanol washed.  
**Pressure reinforcement:** 4 layers of high tensile steel wire.  
**Cover:** Extra thick dual layer TPU sheath.  
**Colour:** ColorGard™ – red inner sheath and black outer sheath.

### TEMPERATURE RANGE

-40°C up to +70°C / -40°F up to 158°F.

### FITTINGS

**NPT Male fitting:** Special steel and stainless steel materials.

#		A	B	ØR	
		mm	mm	mm	bar
101BL-32-32	2 NPT	275.0	129.0	83.0	690
6015X-32-32	2 NPT	244.0	107.0	82.5	690

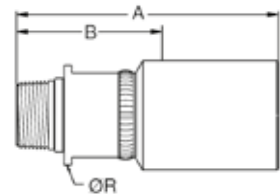

### 1502 Hammerlug union female

#		A	B	
		mm	mm	bar
1HNBL-32-32	4 1/8 - 3 ACME	263.0	117.0	1035
6HN5X-32-32-TC	4 1/8 - 3 ACME	243.0	106.0	1035

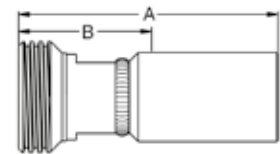

### 1502 Hammerlug union male

#		A	B	
		mm	mm	bar
1HEBL-32-32-FLAT	4 1/8 - 3 ACME	278.3	132.3	1035
6HE5X-32-32-FLATTC	4 1/8 - 3 ACME	292.0	155.0	1035

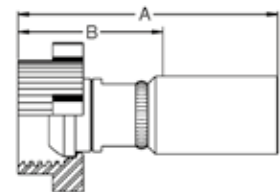

**Note:** DNV Type approval (API 7K and API 17J) with fitting series BL.



**Please Note:** Variety of fittings in mild steel or stainless steel available, other fittings available on request. We reserve the right to make technical changes without notice.