

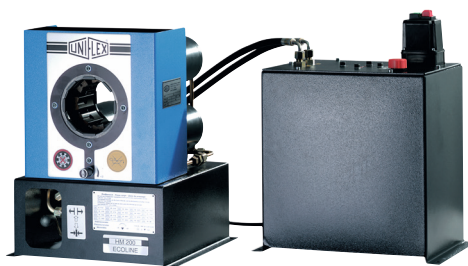

As the unrivaled classic in the 1" field, with its narrow, innovative construction, high level of user friendliness, versatility and long service life, the HM 200 sets the unbeatable standard for quality and cost effectiveness. Its compact construction allows for ergonomic working. The use of different die sets allows pressing of all types of fittings, and the proven greaseless slide bearing technology reduces maintenance costs. The Ecoline model is hydraulically controlled and has a separate tank to save space in workshops.



HM 200



HM 200 Ecoline

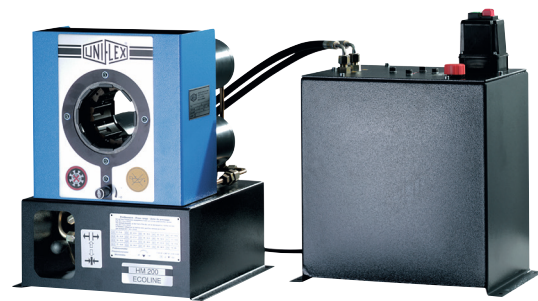

PUU (optional)



HM 200

HM 200 Ecoline

Technical Data	HM 200	HM 200 Ecoline	Type of dies																																																								
Crimp force (kN/Ton)	1,300/130	1,300/130	 <p>239</p> <table border="1"> <thead> <tr> <th>Ø mm</th> <th>mm</th> </tr> </thead> <tbody> <tr><td>6.8</td><td>50</td></tr> <tr><td>9</td><td>50</td></tr> <tr><td>10</td><td>50</td></tr> <tr><td>12</td><td>50</td></tr> <tr><td>14</td><td>60</td></tr> <tr><td>16</td><td>60</td></tr> <tr><td>17</td><td>60</td></tr> <tr><td>19</td><td>60</td></tr> <tr><td>20</td><td>60</td></tr> <tr><td>22</td><td>60</td></tr> <tr><td>24</td><td>60</td></tr> <tr><td>26</td><td>75</td></tr> <tr><td>28</td><td>75</td></tr> <tr><td>30</td><td>75</td></tr> <tr><td>31</td><td>75</td></tr> <tr><td>32</td><td>75</td></tr> <tr><td>34</td><td>75</td></tr> <tr><td>36</td><td>75</td></tr> <tr><td>38</td><td>75</td></tr> <tr><td>39</td><td>75</td></tr> <tr><td>40</td><td>75</td></tr> <tr><td>44</td><td>75</td></tr> <tr><td>47</td><td>75</td></tr> <tr><td>50</td><td>75</td></tr> <tr><td>54</td><td>75</td></tr> <tr><td>57</td><td>75</td></tr> <tr><td>62</td><td>75</td></tr> </tbody> </table>	Ø mm	mm	6.8	50	9	50	10	50	12	50	14	60	16	60	17	60	19	60	20	60	22	60	24	60	26	75	28	75	30	75	31	75	32	75	34	75	36	75	38	75	39	75	40	75	44	75	47	75	50	75	54	75	57	75	62	75
Ø mm	mm																																																										
6.8	50																																																										
9	50																																																										
10	50																																																										
12	50																																																										
14	60																																																										
16	60																																																										
17	60																																																										
19	60																																																										
20	60																																																										
22	60																																																										
24	60																																																										
26	75																																																										
28	75																																																										
30	75																																																										
31	75																																																										
32	75																																																										
34	75																																																										
36	75																																																										
38	75																																																										
39	75																																																										
40	75																																																										
44	75																																																										
47	75																																																										
50	75																																																										
54	75																																																										
57	75																																																										
62	75																																																										
No grease: 20% less friction	✓	✓																																																									
Control	Control A	Control A																																																									
SAE R 12/4SP* 1 piece fitting	1½"	1½"																																																									
SAE R 15/4SH* 2 piece fitting	1"	1"																																																									
SAE R 12/4SP* 2 piece fitting	1¼"	1¼"																																																									
Industrial	2"	2"																																																									
90° Elbows	1½"	1½"																																																									
Max. Crimp range (mm/inch)	70 / 2.76	70 / 2.76																																																									
Opening (mm/inch)	+30 / +1.18	+30 / +1.18																																																									
Opening without dies (mm/inch)	100 / 3.94	100 / 3.94																																																									
Master dies length (mm/inch)	75 / 2.95	75 / 2.95																																																									
Type of dies	239	239																																																									
Speed (mm/sec)																																																											
Close	3.5	3.5																																																									
Crimp	3.5	3.5																																																									
Open	5.9	5.9																																																									
Noise level	69 dBA	69 dBA																																																									
Drive	3 kW 3 VAC	3 kW 3 VAC																																																									
Oil	40 l	40 l (DC 4 l)																																																									
L x W x H (mm)	800 x 530 x 630	420 x 535 x 520																																																									
Power Unit L x W x H (mm)	-	300 x 450 x 560																																																									
Weight	140 kg	92 kg (without power unit), 130 kg (with die package)																																																									
Options																																																											
12 VDC/24 VDC	-	✓																																																									
1 VAC	✓	2.2 kW																																																									
Control C,2/IPC	✓	-																																																									

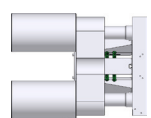

SC = Press tool with Cylinder

* According to the fitting.
 Packages page 28 / Accessories and options page 56

Description



The micrometer allows you to easily set the crimping diameter.



The large opening stroke allows you to pass 90° fittings without changing the crimp dies.



The 12 VDC/24 VDC units offer space- and weight-saving application options, e.g. for fitting service trucks. L x W x H (mm) 441 x 291 x 296; 21 kg



A box with master dies is available in a package.



For mobile applications the HM 200 is also ideally suitable.